

Non-destructive testing of welds —

Part 1: Evaluation of welded joints in
steel, nickel, titanium and their alloys
by radiography — Acceptance levels

The European Standard EN 12517-1:2006 has the status of a
British Standard

ICS 25.160.40

National foreword

This British Standard is the official English language version of EN 12517-1:2006. It supersedes BS EN 12517:1998 which is withdrawn. The UK participation in its preparation was entrusted to Technical Committee WEE/46, Non-destructive testing, which has the responsibility to:

- aid enquirers to understand the text;
- present to the responsible international/European committee any enquiries on the interpretation, or proposals for change, and keep UK interests informed;
- monitor related international and European developments and promulgate them in the UK.

A list of organizations represented on this committee can be obtained on request to its secretary.

Cross-references

The British Standards which implement international or European publications referred to in this document may be found in the BSI Catalogue under the section entitled “International Standards Correspondence Index”, or by using the “Search” facility of the BSI Electronic Catalogue or of British Standards Online.

This publication does not purport to include all the necessary provisions of a contract. Users are responsible for its correct application.

Compliance with a British Standard does not of itself confer immunity from legal obligations.

Summary of pages

This document comprises a front cover, an inside front cover, the EN title page, pages 2 to 15 and a back cover.

The BSI copyright notice displayed in this document indicates when the document was last issued.

This British Standard was published under the authority of the Standards Policy and Strategy Committee on 31 March 2006

© BSI

ISBN 0 580 48044 5

Amendments issued since publication

Amd. No.	Date	Comments

English Version

Non-destructive testing of welds - Part 1: Evaluation of welded joints in steel, nickel, titanium and their alloys by radiography - Acceptance levels

Essais non destructifs des assemblages soudés - Partie 1:
Évaluation par radiographie des assemblages soudés en
acier, nickel, titane et leurs alliages - Niveaux d'acceptation

Zerstörungsfreie Prüfung von Schweißverbindungen - Teil
1: Bewertung von Schweißverbindungen in Stahl, Nickel,
Titan und ihren Legierungen mit Durchstrahlung -
Zulässigkeitsgrenzen

This European Standard was approved by CEN on 6 February 2006.

CEN members are bound to comply with the CEN/CENELEC Internal Regulations which stipulate the conditions for giving this European Standard the status of a national standard without any alteration. Up-to-date lists and bibliographical references concerning such national standards may be obtained on application to the Central Secretariat or to any CEN member.

This European Standard exists in three official versions (English, French, German). A version in any other language made by translation under the responsibility of a CEN member into its own language and notified to the Central Secretariat has the same status as the official versions.

CEN members are the national standards bodies of Austria, Belgium, Cyprus, Czech Republic, Denmark, Estonia, Finland, France, Germany, Greece, Hungary, Iceland, Ireland, Italy, Latvia, Lithuania, Luxembourg, Malta, Netherlands, Norway, Poland, Portugal, Romania, Slovakia, Slovenia, Spain, Sweden, Switzerland and United Kingdom.



EUROPEAN COMMITTEE FOR STANDARDIZATION
COMITÉ EUROPÉEN DE NORMALISATION
EUROPÄISCHES KOMITEE FÜR NORMUNG

Management Centre: rue de Stassart, 36 B-1050 Brussels

Contents

Page

Foreword.....	3
1 Scope	4
2 Normative references.....	4
3 Radiographic technique.....	4
4 General.....	5
5 Acceptance levels.....	5
Annex A (informative) Guide to the limitations of radiographic testing.....	10
A.1 Volumetric imperfections in butt welds.....	10
A.2 Cracks in butt welds.....	10
A.3 Planar imperfections in butt welds.....	10
Annex B (informative) Examples for determination of area percentage (%) of imperfections.....	11
Annex C (normative) Sum of acceptable areas	13
Bibliography.....	15

Foreword

This document (EN 12517-1:2006) has been prepared by Technical Committee CEN/TC 121 "Welding", the secretariat of which is held by DIN.

This European Standard shall be given the status of a national standard, either by publication of an identical text or by endorsement, at the latest by September 2006, and conflicting national standards shall be withdrawn at the latest by September 2006.

This document supersedes EN 12517:1998.

This document has been prepared under a mandate given to CEN by the European Commission and the European Free Trade Association, and supports essential requirements of EU Directive(s).

EN 12517 comprises a series of European Standards for industrial radiographic films which is made up of the following:

EN 12517-1 Non-destructive testing of welds – Part 1: Evaluation of welded joints in steel, nickel, titanium and their alloys by radiography – Acceptance levels

EN 12517-2 Non-destructive testing of welds – Part 2: Evaluation of welded joints in aluminium and its alloys by radiography – Acceptance levels

According to the CEN/CENELEC Internal Regulations, the national standards organizations of the following countries are bound to implement this European Standard: Austria, Belgium, Cyprus, Czech Republic, Denmark, Estonia, Finland, France, Germany, Greece, Hungary, Iceland, Ireland, Italy, Latvia, Lithuania, Luxembourg, Malta, Netherlands, Norway, Poland, Portugal, Romania, Slovakia, Slovenia, Spain, Sweden, Switzerland and United Kingdom.

1 Scope

This document specifies acceptance levels for indications from imperfections in butt welds of steel, nickel, titanium and their alloys detected by radiographic testing. If agreed, the acceptance levels may be applied to other types of welds or materials.

The acceptance levels may be related to welding standards, application standards, specifications or codes. This European Standard assumes that the radiographic testing has been carried out in accordance with EN 1435.

When assessing whether a weld meets the requirements specified for a weld quality level, the sizes of imperfections permitted by standards are compared with the dimensions of indications revealed by a radiograph made of the weld.

2 Normative references

The following referenced documents are indispensable for the application of this European Standard. For dated references, only the edition cited applies. For undated references, the latest edition of the referenced document (including any amendments) applies.

EN 1435, *Non-destructive examination of welds — Radiographic examination of welded joints*

EN ISO 5817, *Welding — Fusion-welded joints in steel, nickel, titanium and their alloys (beam welding excluded) — Quality levels for imperfections (ISO 5817:2003)*

EN ISO 6520-1, *Welding and allied processes — Classification of geometric imperfections in metallic materials — Part 1: Fusion welding (ISO 6520-1:1998)*

3 Radiographic technique

Depending on the weld quality level, radiographic technique A or B in accordance with EN 1435 is used as shown in Table 1.

Table 1 – Radiographic testing

Quality levels in accordance with EN ISO 5817	Testing techniques and classes in accordance with EN 1435	Acceptance levels in accordance with EN 12517
B	B	1
C	B ^a	2
D	A	3
^a However, the minimum number of exposure for circumferential weld testing may correspond to the requirements of class A of EN 1435.		

Table 2 – Acceptance levels for internal indications in butt welds

No.	Type of internal imperfections in accordance with EN ISO 6520-1	Acceptance level 3 ^a	Acceptance level 2 ^a	Acceptance level 1
1	Cracks (100)	Not permitted	Not permitted	Not permitted
2a	Porosity and gas pores (2012, 2011) Single layer	$A \leq 2,5 \%$ $d \leq 0,4s$, max. 5 mm $L = 100$ mm	$A \leq 1,5 \%$ $d \leq 0,3s$, max. 4 mm $L = 100$ mm	$A \leq 1 \%$ $d \leq 0,2s$, max. 3 mm $L = 100$ mm
2b	Porosity and gas pores (2012, 2011) Multilayer	$A \leq 5 \%$ $d \leq 0,4s$, max. 5 mm $L = 100$ mm	$A \leq 3 \%$ $d \leq 0,3s$, max. 4 mm $L = 100$ mm	$A \leq 2 \%$ $d \leq 0,2s$, max. 3 mm $L = 100$ mm
3 ^d	Clustered (localized) porosity (2013)	$A \leq 16\%$ $d \leq 0,4s$, max. 4 mm $L = 100$ mm	$A \leq 8\%$ $d \leq 0,3s$, max. 3 mm $L = 100$ mm	$A \leq 4\%$ $d \leq 0,2s$, max. 2 mm $L = 100$ mm
4a ^c	Linear porosity (2014) Single layer	$A \leq 8 \%$ $d \leq 0,4s$, max. 4 mm $L = 100$ mm	$A \leq 4 \%$ $d \leq 0,3s$, max. 3 mm $L = 100$ mm	$A \leq 2 \%$ $d \leq 0,2s$, max. 2 mm $L = 100$ mm
4b ^c	Linear porosity (2014) Multilayer	$A \leq 16 \%$ $d \leq 0,4s$, max. 4 mm $L = 100$ mm	$A \leq 8 \%$ $d \leq 0,3s$, max. 3 mm $L = 100$ mm	$A \leq 4 \%$ $d \leq 0,2s$, max. 2 mm $L = 100$ mm
5 ^u	Elongated cavities (2015) and wormholes (2016)	$h < 0,4s$, max. 4 mm $\Sigma l \leq s$, max. 75 mm, $L=100$ mm	$h < 0,3s$, max. 3 mm $\Sigma l \leq s$, max. 50 mm, $L=100$ mm	$h < 0,2s$, max. 2 mm $\Sigma l \leq s$, max. 25 mm, $L=100$ mm
6 ^u	Shrinkage cavity (202) (other than crater pipes)	$h < 0,4s$, max. 4 mm $l \leq 25$ mm	Not permitted	Not permitted
7	Crater pipe (2024)	$h \leq 0,2t$, max. 2 mm $l \leq 0,2t$, max. 2 mm	Not permitted	Not permitted
8 ^u	Slag inclusions (301), flux inclusions (302) and oxide inclusions (303)	$h < 0,4s$, max. 4 mm $\Sigma l \leq s$, max. 75 mm $L = 100$ mm	$h < 0,3s$, max. 3 mm $\Sigma l \leq s$, max. 50 mm $L = 100$ mm	$h < 0,2s$, max. 2 mm $\Sigma l \leq s$, max. 25 mm $L = 100$ mm
9	Metallic inclusions (304) (other than copper)	$l \leq 0,4s$, max. 4 mm	$l \leq 0,3s$, max. 3 mm	$l \leq 0,2s$, max. 2 mm

(to be continued)

Table 2 (*concluded*)

No.	Type of internal imperfections in accordance with EN ISO 6520-1	Acceptance level 3 a	Acceptance level 2 a	Acceptance level 1
10	Copper inclusions (3042)	Not permitted	Not permitted	Not permitted
11e	Lack of fusion (401)	Permitted, but only intermittently and not breaking the surface $\Sigma l \leq 25 \text{ mm}$, $L = 100 \text{ mm}$	Not permitted	Not permitted
12e	Lack of penetration (402)	$\Sigma l \leq 25 \text{ mm}$, $L = 100 \text{ mm}$	Not permitted	Not permitted
<p>a Acceptance levels 3 and 2 may be specified with suffix X, which denotes that all indications over 25 mm are unacceptable.</p> <p>b See Annex C, Figure C.1 and Figure C.2 (normative) c See Annex C, Figure C.3 and Figure C.4 (normative) d See Annex C, Figure C.5 and Figure C.6 (normative)</p> <p>e If the length of the weld is below 100 mm, then the maximum length of indications shall not exceed 25% of that weld.</p>				

**Table 3 – Surface imperfections: The acceptance levels are those defined for visual testing.
These defects are normally evaluated by visual testing**

No.	Type of surface imperfections in accordance with EN ISO 6520-1	Acceptance level 3 a	Acceptance level 2 a	Acceptance level 1
13	Crater cracks (104)	Not permitted	Not permitted	Not permitted
14a	Undercut, continues and intermittent (5011,5012)	Smooth transition is required For $t > 3$ mm $h \leq 0,2t$, max. 1 mm For $0,5 \text{ mm} \leq t \leq 3 \text{ mm}$ $l \leq 25 \text{ mm}$, $h \leq 0,2t$	Smooth transition is required For $t > 3$ mm $h \leq 0,1t$, max. 0,5 mm For $0,5 \text{ mm} \leq t \leq 3 \text{ mm}$ $l \leq 25 \text{ mm}$, $h \leq 0,1t$	Smooth transition is required For $t > 3$ mm $h \leq 0,05t$, max. 0,5 mm For $0,5 \text{ mm} \leq t \leq 3 \text{ mm}$ not permitted
14b	Shrinkage groove (root undercut 5013)	Smooth transition is required For $t > 3$ mm $l \leq 25 \text{ mm}$, $h \leq 0,2t$, max. 2 mm, For $0,5 \text{ mm} \leq t \leq 3 \text{ mm}$ $h \leq 0,2 \text{ mm} + 0,1t$	Smooth transition is required For $t > 3$ mm $l \leq 25 \text{ mm}$, $h \leq 0,1t$, max. 1 mm For $0,5 \text{ mm} \leq t \leq 3 \text{ mm}$ $l \leq 25 \text{ mm}$, $h \leq 0,1t$	Smooth transition is required For $t > 3$ mm $l \leq 25 \text{ mm}$, $h \leq 0,05t$, max. 0,5 mm For $0,5 \text{ mm} \leq t \leq 3 \text{ mm}$ Not permitted
15a	Excess penetration (504) $0,5 \text{ mm} \leq t \leq 3 \text{ mm}$	$h \leq 1 \text{ mm} + 0,6 b$	$h \leq 1 \text{ mm} + 0,3 b$	$h \leq 1 \text{ mm} + 0,1 b$
15b	Excess penetration (504) $t > 3 \text{ mm}$	$h \leq 1 \text{ mm} + 1,0 b$, max. 5 mm	$h \leq 1 \text{ mm} + 0,6 b$, max. 4 mm	$h \leq 1 \text{ mm} + 0,2 b$, max. 3 mm
16	Stray arc (601)	Permitted, if the properties of the parent metal are not affected	Not permitted	Not permitted
17	Spatter (602)	Acceptance depends on application, e.g. material, corrosion protection		
18a	Root concavity (515) $0,5 \text{ mm} \leq s \leq 3 \text{ mm}$	$h \leq 0,2 \text{ mm} + 0,1 t$	$l \leq 25 \text{ mm}$: $h \leq 0,1 t$	Not permitted

(to be continued)

Table 3 (concluded)

No.	Type of surface imperfections in accordance with EN ISO 6520-1	Acceptance level 3 a	Acceptance level 2 a	Acceptance level 1
18b	Root concavity (515) $s > 3 \text{ mm}$	$l \leq 25 \text{ mm}$, $h \leq 0,2 t$, max. 2 mm	$l \leq 25 \text{ mm}$, $h \leq 0,1 t$, max. 1 mm	$l \leq 25 \text{ mm}$, $h \leq 0,05 t$, max. 0,5 mm
19	Poor restart (517) $s \leq 0,5 \text{ mm}$	Permitted, The limit depends on the type of imperfection (see EN ISO 5817)	Not permitted	Not permitted
20a	Sagging (509) Incompletely filled groove (511) $0,5 \text{ mm} \leq s \leq 3 \text{ mm}$	$l \leq 25 \text{ mm}$, $h \leq 0,25 t$	$l \leq 25 \text{ mm}$, $h \leq 0,1 t$	Not permitted
20b	Sagging (509) Incompletely filled groove (511) $s > 3 \text{ mm}$	$l \leq 25 \text{ mm}$, $h \leq 0,25 t$, max. 2 mm	$l \leq 25 \text{ mm}$, $h \leq 0,1 t$, max. 1 mm	$l \leq 25 \text{ mm}$, $h \leq 0,05 t$, max. 0,5 mm
21a	Linear misalignment (507) $0,5 \text{ mm} \leq s \leq 3 \text{ mm}$	$h \leq 0,2 \text{ mm} + 0,25 t$	$h \leq 0,2 \text{ mm} + 0,15 t$	$h \leq 0,2 \text{ mm} + 0,1 t$
21b	Linear misalignment, longitudinal welds (507) $s > 3 \text{ mm}$	$h \leq 0,25 t$, max. 5 mm	$h \leq 0,15 t$, max. 4 mm	$h \leq 0,1 t$, max. 3 mm
21c	Linear misalignment, circumferential welds (507) $s \leq 0,5 \text{ mm}$	$h \leq 0,5 t$, max. 4 mm	$h \leq 0,5 t$, max. 3 mm	$h \leq 0,5 t$, max. 2 mm
a Acceptance levels 3 and 2 may be specified with suffix X, which denotes that all indications over 25 mm are unacceptable.				

Annex A (informative)

Guide to the limitations of radiographic testing

NOTE The numbers between brackets conform to those used in EN ISO 6520-1.

A.1 Volumetric imperfections in butt welds

Porosities and gas pores (2011, 2013, 2015 and 2017)

Wormholes and elongated cavities (2016 and 2015)

Solid inclusions (300)

Copper inclusions (3042)

The above imperfections listed in Table 2 will be readily detected using radiographic technique A or B of EN 1435 as shown in Table 1 of this European Standard.

A.2 Cracks in butt welds

Crater cracks (104)

Cracks (100)

The detectability of cracks by radiographic testing depends on the crack height, the ramification (presence of branching parts), opening width, direction of the X-ray beam to crack orientation and radiographic technique parameters.

Reliable detection of all cracks is therefore limited. The use of radiographic technique B or better, as specified in EN 1435, will provide better crack detectability than radiographic technique A.

A.3 Planar imperfections in butt welds

Lack of fusion (401)

Lack of penetration (402)

The detection of lack of fusion and lack of penetration depends on characteristics of imperfections and radiographic technique parameters.

Lack of side-wall fusion will probably not be detected (except it is associated with other imperfections such as slag inclusions) unless it is radiographed in direction of the side-wall.

Annex B

(informative)

Examples for determination of area percentage (%) of imperfections

The following figures give a presentation of different area percentage (%) of imperfections. This should assist the assessment of imperfections on radiographs and fracture surfaces.

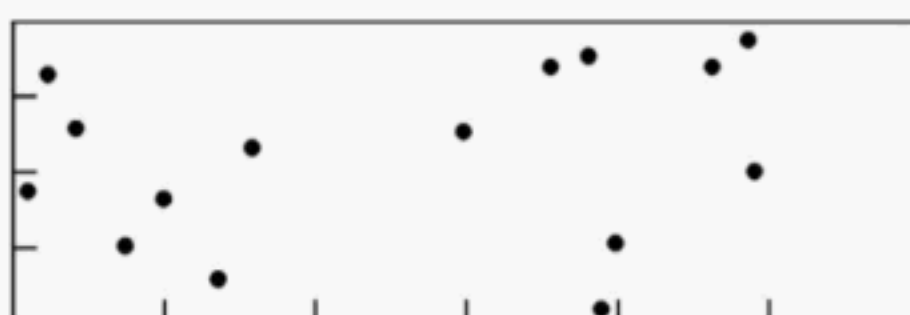

Figure B.1 — 1 %



Figure B.2 — 1,5 %



Figure B.3 — 2 %



Figure B.4 — 2,5 %



Figure B.5 — 3 %



Figure B.6 — 4 %



Figure B.7 — 5 %



Figure B.8 — 8 %



Figure B.9 — 16 %

Annex C (normative)

Sum of acceptable areas

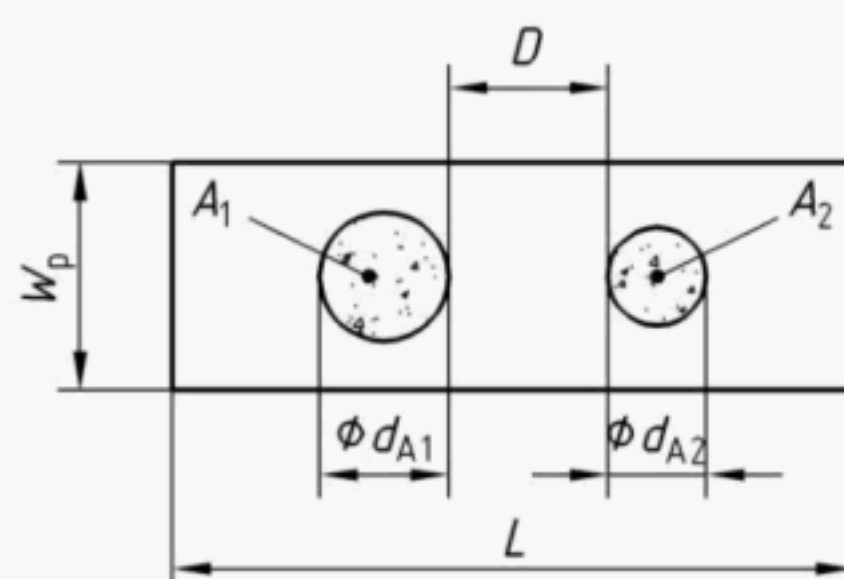

Figure C.1 — Clustered porosity, $D > d_{A2}$

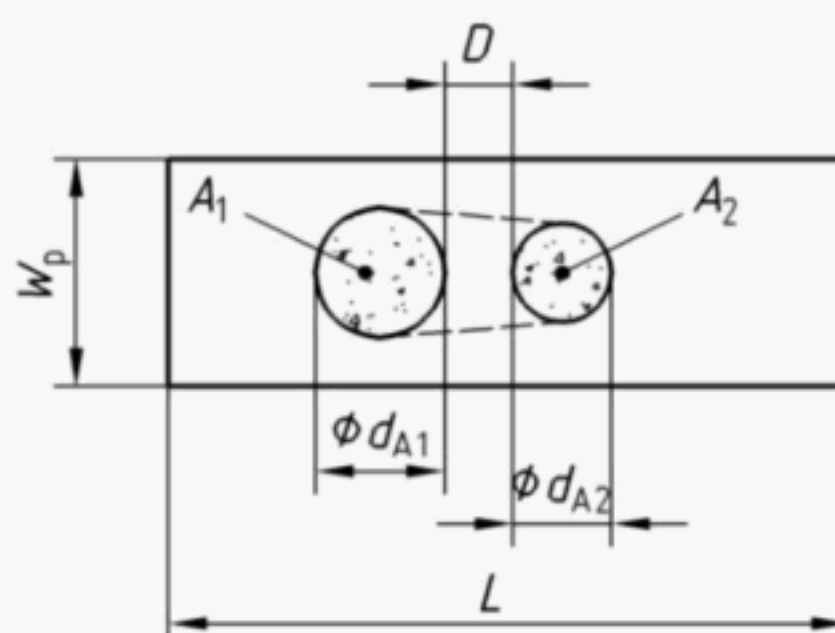

Figure C.2 — Clustered porosity, $D < d_{A2}$

The sum of the different pore areas ($A_1 + A_2 + \dots$) related to the evaluation area $L \times w_p$ (Figure C.1).

If D is less than d_{A1} or d_{A2} , whatever is smaller, an envelope surrounding the porosity area $A_1 + A_2$ shall be considered as one area of imperfection (Figure C.2).

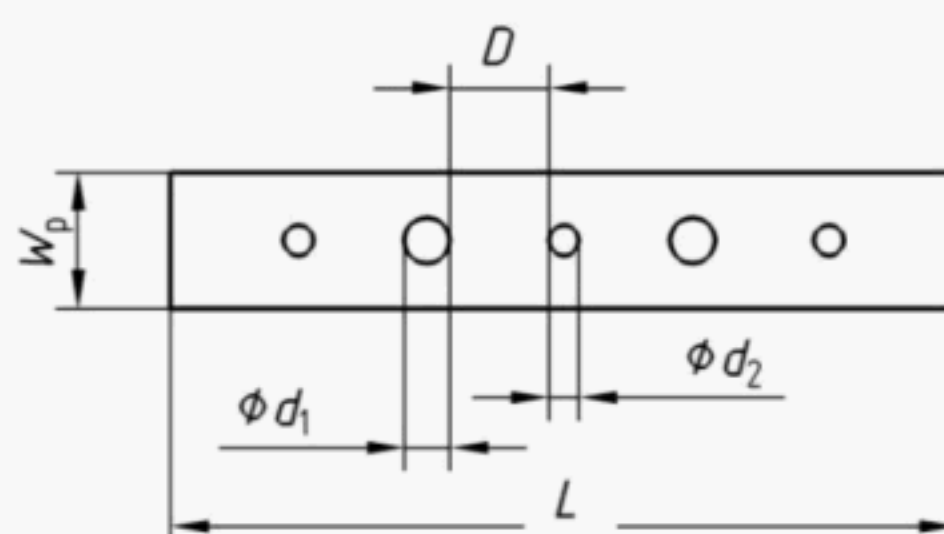

Figure C.3 — Linear porosity, $D > d_2$

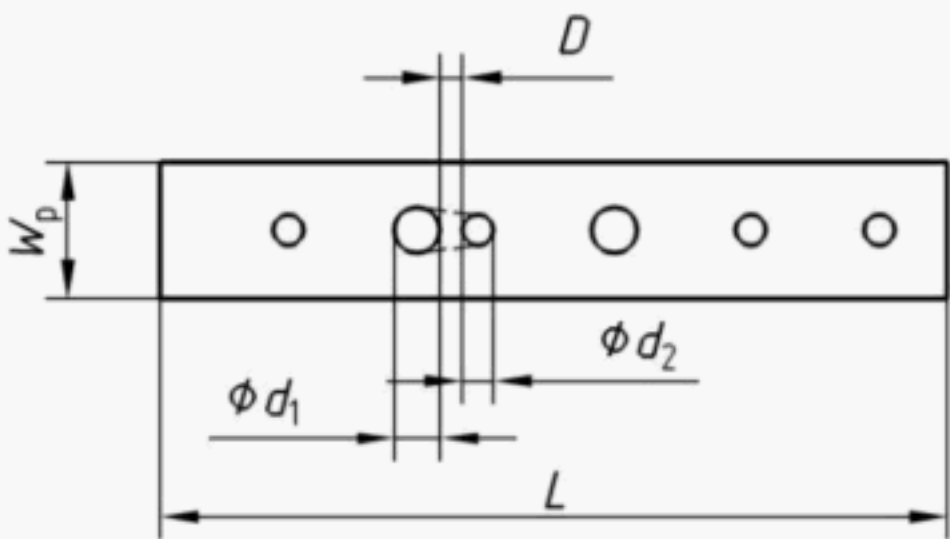
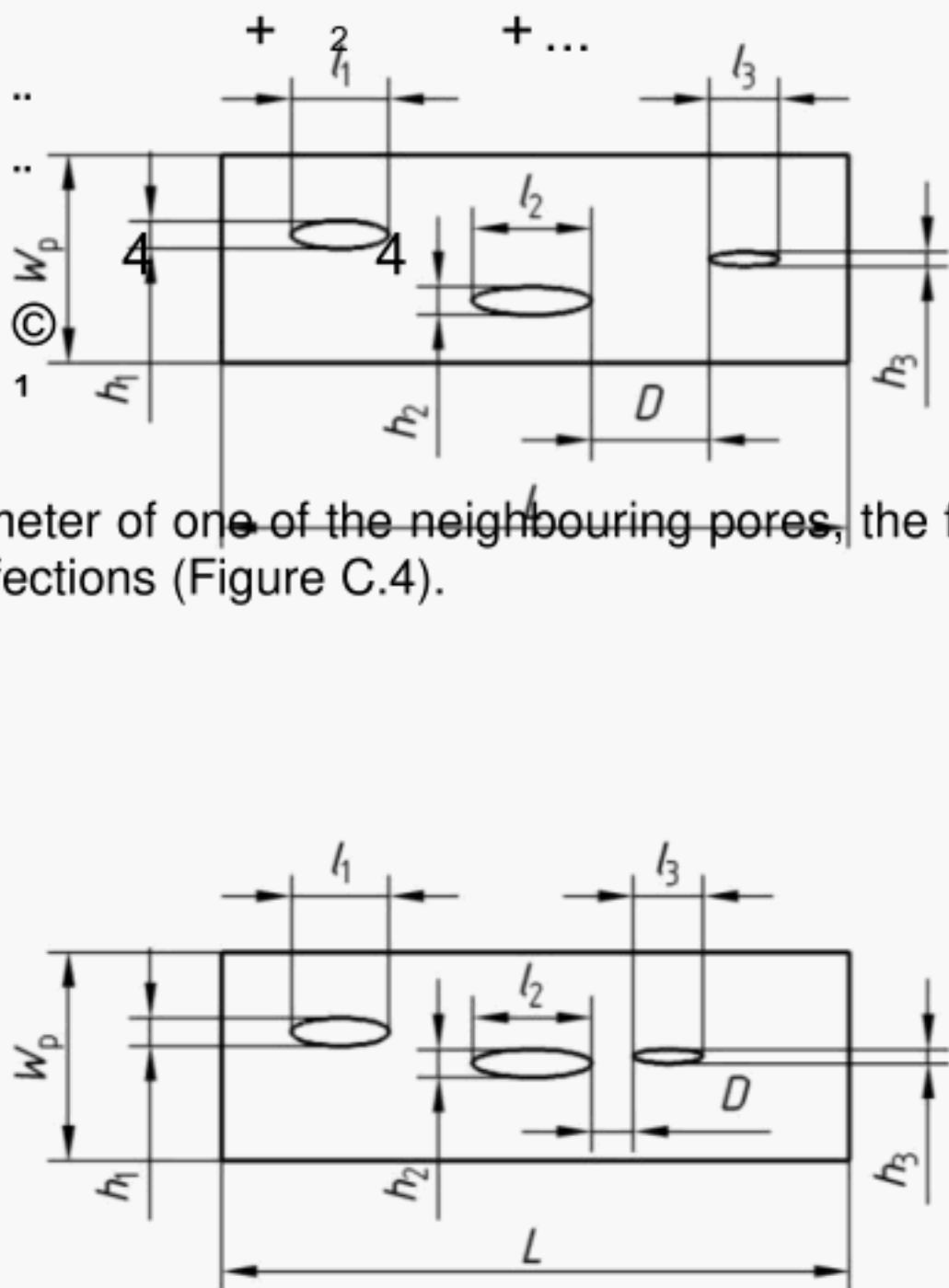

Figure C.4 — Linear porosity, $D < d_2$

§ . related to the evaluation area $L \times w_p$ (Figure C.3).

$$\frac{\sum_{i=1}^n \pi d_i^2}{4Lw_p}$$

The sum of the different pore areas



If D is smaller than the smaller diameter of one of the neighbouring pores, the full connected area of the two pores is to be taken into the sum of imperfections (Figure C.4).

Figure C.5 — Elongated cavities and wormholes, $D > l_3$

Figure C.6 — Elongated cavities and wormholes, $D < l_3$

The sum of the length of indications Σl shall be determined for each testing length L (Figure C.5).

If D is smaller than the shorter length of one of the neighbouring imperfections, the full connection of the two imperfections is to be taken into the sum of imperfections (Figure C.6).

Bibliography

- [1] EN 970, *Non-destructive examination of fusion welds — Visual examination*
- [2] EN 12062, *Non-destructive examination of welds — General rules for metallic materials*
- [3] IIW catalogue of reference radiographs for assessment of weld imperfections according to ISO 5817

BSI — British Standards Institution

BSI is the independent national body responsible for preparing British Standards. It presents the UK view on standards in Europe and at the international level. It is incorporated by Royal Charter.

Revisions

British Standards are updated by amendment or revision. Users of British Standards should make sure that they possess the latest amendments or editions.

It is the constant aim of BSI to improve the quality of our products and services. We would be grateful if anyone finding an inaccuracy or ambiguity while using this British Standard would inform the Secretary of the technical committee responsible, the identity of which can be found on the inside front cover. Tel: +44 (0)20 8996 9000. Fax: +44 (0)20 8996 7400.

BSI offers members an individual updating service called PLUS which ensures that subscribers automatically receive the latest editions of standards.

Buying standards

Orders for all BSI, international and foreign standards publications should be addressed to Customer Services. Tel: +44 (0)20 8996 9001. Fax: +44 (0)20 8996 7001. Email: orders@bsi-global.com. Standards are also available from the BSI website at <http://www.bsi-global.com>.

In response to orders for international standards, it is BSI policy to supply the BSI implementation of those that have been published as British Standards, unless otherwise requested.

Information on standards

BSI provides a wide range of information on national, European and international standards through its Library and its Technical Help to Exporters Service. Various BSI electronic information services are also available which give details on all its products and services. Contact the Information Centre. Tel: +44 (0)20 8996 7111. Fax: +44 (0)20 8996 7048. Email: info@bsi-global.com.

Subscribing members of BSI are kept up to date with standards developments and receive substantial discounts on the purchase price of standards. For details of these and other benefits contact Membership Administration. Tel: +44 (0)20 8996 7002. Fax: +44 (0)20 8996 7001. Email: membership@bsi-global.com.

Information regarding online access to British Standards via British Standards Online can be found at <http://www.bsi-global.com/bsonline>.

Further information about BSI is available on the BSI website at <http://www.bsi-global.com>.

Copyright

Copyright subsists in all BSI publications. BSI also holds the copyright, in the UK, of the publications of the international standardization bodies. Except as permitted under the Copyright, Designs and Patents Act 1988 no extract may be reproduced, stored in a retrieval system or transmitted in any form or by any means – electronic, photocopying, recording or otherwise – without prior written permission from BSI.

This does not preclude the free use, in the course of implementing the standard, of necessary details such as symbols, and size, type or grade designations. If these details are to be used for any other purpose than implementation then the prior written permission of BSI must be obtained.

Details and advice can be obtained from the Copyright & Licensing Manager. Tel: +44 (0)20 8996 7070. Fax: +44 (0)20 8996 7553. Email: copyright@bsi-global.com.